

- Plastic Waterproof Connector EDB series,
- Type: Angled Female Socket,
- Gender: Female,
- Termination : PCB
- Number of cores:
25,44H,5W5,9W4,13W3,17W2,21W1 pins,
- Flame retardant grade : V-0
- Certification: CE/RoHS.

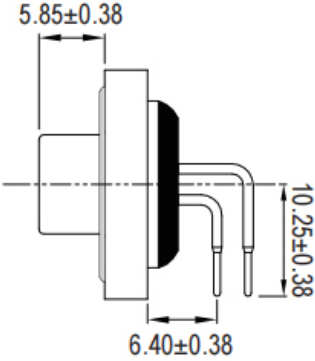

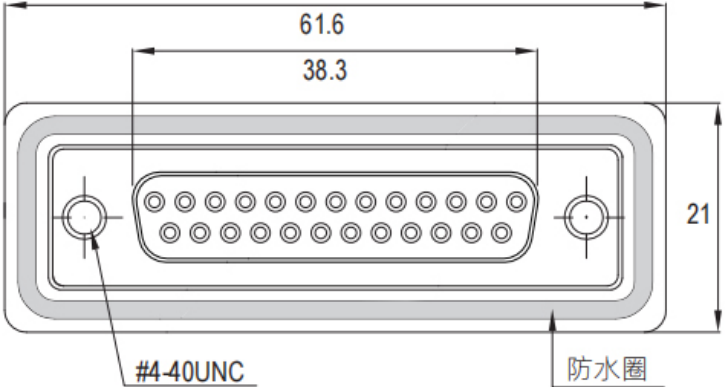



PRODUCT PARAMETERS

Rated current :	10A/20A/30A/40A
Rated voltage :	1000 V
Withstand voltage :	500 V
Insulation impedance :	5000 MΩ
Contact impedance :	10 mΩ
Pulling Force :	Products comply with IEC60807-3
Wiring range :	8mm~14mm
Durability :	≥500次
Applicable temperature :	-55°C ~ +105°C
Shell material :	Thermoplastic PA66 ,Flame retardant grade : V-0
Waterproof grade :	IP65/ IP67
Products comply :	CECC 7501-802.IEC 60807-3

DIMENSIONS



ELECTRICAL PARAMETERS

芯数排列 PINS ARRANGEMENT					
芯位图 Pins Arrangement	 25		 44H		 5W5
芯数 Pins	小针:25 Small needle:25		小针:44 Small needle:44		大针:5 Large needle:5
芯位图 Pins Arrangement	 13W3		 17W2		 21W1
芯数 Pins	大针:3 Large needle:3	小针:10 Small needle:10	大针:2 Large needle:2	小针:15 Small needle:15	大针:1 Large needle:1

技术参数 TECHNICAL PARAMETERS					
针规 Pin Gage	小针 Small needle	大针 Large needle			
线规 Wire gauge	20 AWG	14 AWG	10 AWG	8 AWG	6 AWG
引脚类型 Pin type	φ1	φ1.7	φ2.8	φ3.2	φ4.6
额定电流 Rated current	5A	10A	20A	30A	40A

接线范围 Wiring range	8.1mm-14.0mm
防水等级 Waterproof grade	IP65/IP67
插拔次数 Durability	500
适应温度 Applicable temperature	-55°C~105°C
额定电压 Rated voltage	1000V

Ordering products

Product Name	Pins	Max Pin Wire gauge	Rated current	Model	3D Download	2D Download
EDB3-Angled Female Socket(PCB)	25	20 AWG	5A	EDB3-F25-PPL		↓
EDB3-Angled Female Socket(PCB)	44H	20 AWG	5A	EDB3-F44H-PPL		
EDB3-Angled Female Socket(PCB)	5W5	20 AWG	5A	EDB3-F5W5-PPL		
EDB3-Angled Female Socket(PCB)	9W4C	20 AWG	5A	EDB3-F9W4C-PPL		

EDB3-Angled Female Socket(PCB)	13W3	20 AWG	5A	EDB3-F13W3-PPL		
EDB3-Angled Female Socket(PCB)	17W2	20 AWG	5A	EDB3-F17W2-PPL		
EDB3-Angled Female Socket(PCB)	21W1	20 AWG	5A	EDB3-F21W1-PPL		
EDB3-Angled Female Socket(PCB)	5W5	14 AWG	10A	EDB3-F5W5-PPL14		
EDB3-Angled Female Socket(PCB)	9W4C	14 AWG	5A/10A	EDB3-F9W4C-PPL14		
EDB3-Angled Female Socket(PCB)	13W3	14 AWG	5A/10A	EDB3-F13W3-PPL14		
EDB3-Angled Female Socket(PCB)	17W2	14 AWG	5A/10A	EDB3-F17W2-PPL14		
EDB3-Angled Female Socket(PCB)	21W1	14 AWG	5A/10A	EDB3-F21W1-PPL14		
EDB3-Angled Female Socket(PCB)	5W5	10 AWG	20A	EDB3-F5W5-PPL20		
EDB3-Angled Female Socket(PCB)	9W4C	10 AWG	5A/20A	EDB3-F9W4C-PPL20		
EDB3-Angled Female Socket(PCB)	13W3	10 AWG	5A/20A	EDB3-F13W3-PPL20		
EDB3-Angled Female Socket(PCB)	17W2	10 AWG	5A/20A	EDB3-F17W2-PPL20		
EDB3-Angled Female Socket(PCB)	21W1	10 AWG	5A/20A	EDB3-F21W1-PPL20		
EDB3-Angled Female Socket(PCB)	5W5	08 AWG	30A	EDB3-F5W5-PPL30		
EDB3-Angled Female Socket(PCB)	9W4C	08 AWG	5A/30A	EDB3-F9W4C-PPL30		
EDB3-Angled Female Socket(PCB)	13W3	08 AWG	5A/30A	EDB3-F13W3-PPL30		
EDB3-Angled Female Socket(PCB)	17W2	08 AWG	5A/30A	EDB3-F17W2-PPL30		
EDB3-Angled Female Socket(PCB)	21W1	08 AWG	5A/30A	EDB3-F21W1-PPL30		
EDB3-Angled Female Socket(PCB)	5W5	06 AWG	40A	EDB3-F5W5-PPL40		
EDB3-Angled Female Socket(PCB)	9W4C	06 AWG	5A/40A	EDB3-F9W4C-PPL40		
EDB3-Angled Female Socket(PCB)	13W3	06 AWG	5A/40A	EDB3-F13W3-PPL40		
EDB3-Angled Female Socket(PCB)	17W2	06 AWG	5A/40A	EDB3-F17W2-PPL40		
EDB3-Angled Female Socket(PCB)	21W1	06 AWG	5A/40A	EDB3-F21W1-PPL40		

Data Download

PRODUCT CATALOG	CAZN-Plastic waterproof connector series
EMC	EMC Certificate 、 EMC Report 、 REACH233 Report
RoHS	Certificate 、 Report
WATERPROOF TEST REPORT	Certificate 、 Report